

# WENDOVER CYCLEWAY SCHEME - ROUTE 2 - SHEET 1

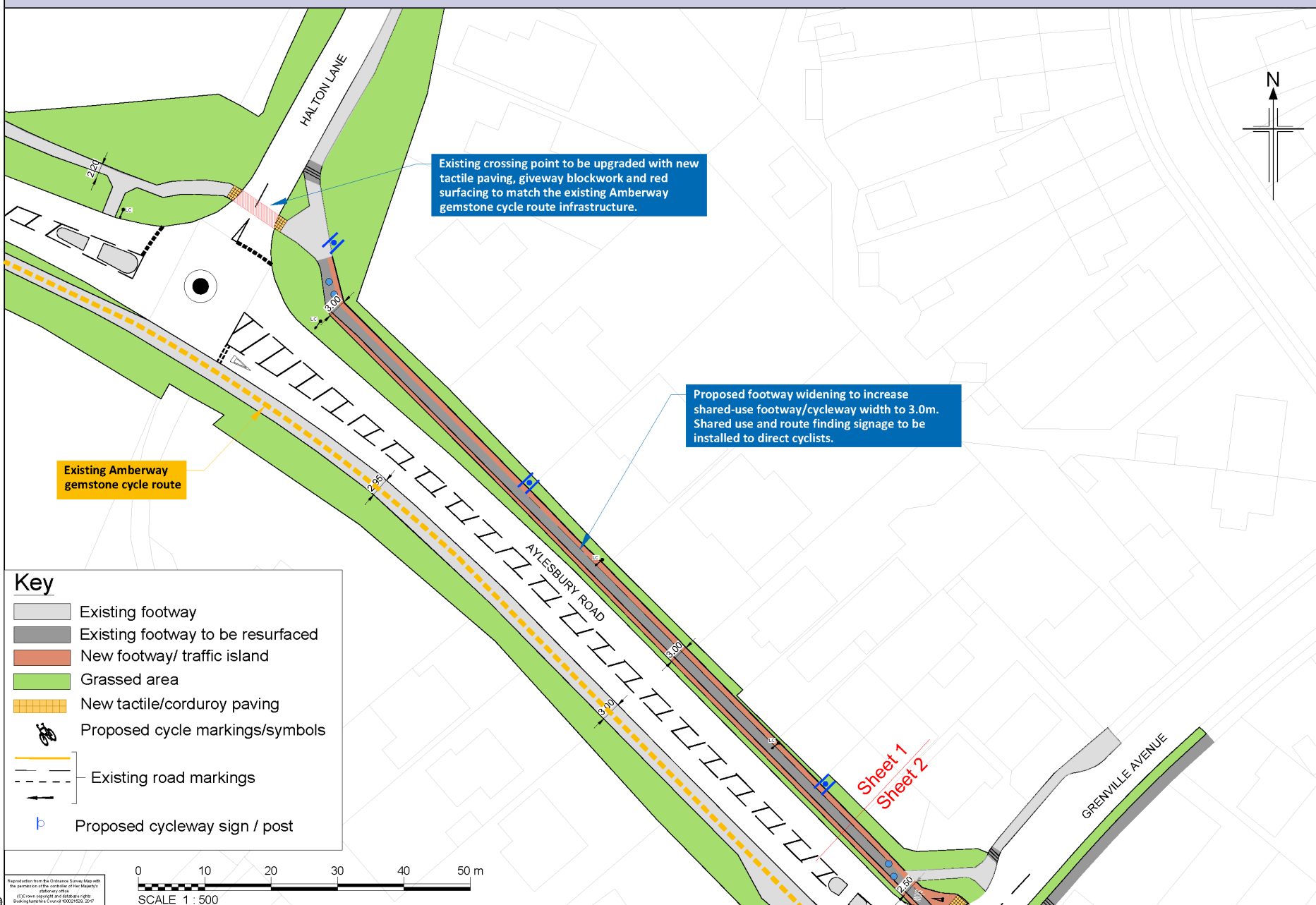

**Key**

- Existing footway
- Existing footway to be resurfaced
- New footway/ traffic island
- Grassed area
- New tactile/corduroy paving
- Proposed cycle markings/symbols
- Existing road markings
- Proposed cycleway sign / post

**Annotations:**

- Existing crossing point to be upgraded with new tactile paving, giveway blockwork and red surfacing to match the existing Amberway gemstone cycle route infrastructure.
- Proposed footway widening to increase shared-use footway/cycleway width to 3.0m. Shared use and route finding signage to be installed to direct cyclists.
- Existing Amberway gemstone cycle route
- Existing Amberway gemstone cycle route
- Existing Amberway gemstone cycle route

**Map Labels:** GRENVILLE AVENUE, AYLESBURY ROAD, CASTLE PARK ROAD, BUS STOP, SHEET 1, SHEET 2, WHERE EXTEND

**Scale:** 0 10 20 30 40 50 m  
SCALE 1 : 500

Reproduction from the Ordnance Survey Map with the permission of the controller of Her Majesty's Stationery Office.  
© Crown copyright and database right.  
Buckinghamshire Council 100021524, 2017.

C:\Users\ackwood\OneDrive - JacobsWendover\Cycleways\E1-2-3\_Consultation\_DL\_160221.dwg - 19/02/2021 11:43:51 - A3 (14) - Lockwood